

SIGNATURE

NORTH EAST

OFFICIALLY RATED THE NO.1 ESTATE AGENT IN THE NORTH EAST





📍 Lynn Road, North Shields NE29 8HS

Lynn Road, North Shields NE29 8HS

Offers Over £190,000

Signature North East are delighted to welcome to the market this well-presented three bedroom semi-detached property, situated on Lynn Road in North Shields. The property is ideally located within easy reach of North Shields town centre, offering access to a range of shops, cafes and essential amenities. The nearby coastal town of Tynemouth provides a popular setting with beaches, restaurants and weekend markets. Excellent transport links are available via the Tyne and Wear Metro, with direct connections to Newcastle upon Tyne, alongside convenient road links including the Coast Road.

Upon entering the property, you are welcomed into a central hallway leading to a bright and spacious living room, offering ample space for furnishings and featuring a fireplace as a focal point. To the rear, the open plan kitchen and dining area provides a practical layout with space for a dining table. The kitchen includes a range of wall and base units, worktops, integrated oven and hob, and access to the rear garden through French doors.

To the first floor, there are three bedrooms. Bedrooms one and two can comfortably accommodate double beds, while bedroom three is suitable for a single bed or home office. Bedrooms two and three also benefit from fitted cupboards for additional storage. The bathroom completes this floor, fitted with a bath with overhead shower, hand basin and W.C.

Externally, the property offers a generous rear garden laid with lawn and gravel, along with a patio and decking area, ideal for outdoor seating. There is also a front garden and an outhouse for storage. On-street parking is available at the front of the property.



PLEASE NOTE THAT THE VENDOR HAS CERTIFIED THE PROPERTY INFORMATION AND IMAGES.

PROPERTY FLOORPLAN

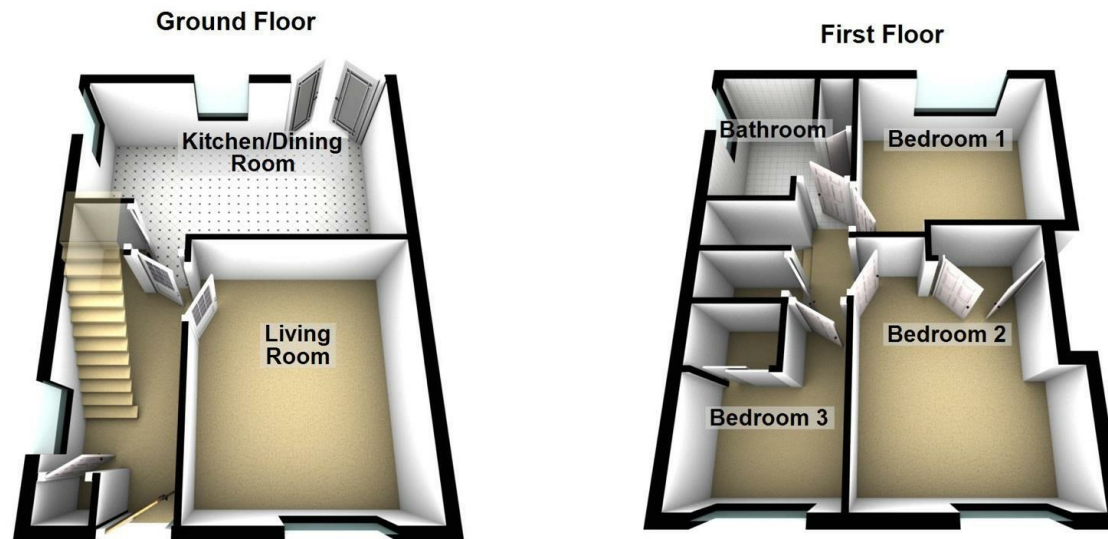

Total area: approx. 80.7 sq. metres (868.9 sq. feet)

Measurements:

Living Room
13'4" x 11'2"

Kitchen / Dining Room
10'10" x 18'11"

Bedroom One
9'3" x 10'11"

Bedroom Two
12'7" x 10'11"

Bedroom Three
7'7" x 9'3"

Bathroom
5'4" x 7'10"

Energy Efficiency Rating

	Current	Potential
Very energy efficient - lower running costs		
(92 plus) A		
(81-91) B		82
(69-80) C		
(55-68) D	66	
(39-54) E		
(21-38) F		
(1-20) G		
Not energy efficient - higher running costs		
England & Wales		EU Directive 2002/91/EC 





More 5 Star Customer Reviews than any other Agent based in the North East on allAgents.co.uk



SALES

LETTINGS

FINANCE

LAW

WE COVER THE WHOLE OF THE NORTH EAST

Whitley Bay
0191 251 3344

Cramlington
01670 897 213

Tynemouth
0191 296 6689

Morpeth
01670 513 966

Ponteland
01661 820 082

Wallsend
0191 432 4151

Alnwick
01665 511 800

Heaton
0191 432 4275

Forest Hall
0191 266 9966

Other locations
0191 640 3523

Newcastle
0191 640 2284

Durham
0191 303 8252

Gosforth
0191 640 3523

Sunderland
0191 543 6390

Whickham
0191 432 5102

Gateshead
0191 432 4294

Jesmond
0191 281 1037

Killingworth
0191 640 3602

Ryton
0191 413 9845

Head Office &
Lettings
0191 253 4815

*Highest recommended 5-star reviews than any other Estate Agent based in the North East on allAgents.co.uk - The UK's Largest Customer Review Website for the Property Industry & Awarded Best Estate Agency 2018 & 2019 - North East England by SME News